

# D.D.A.

## DWARKA PROJECT

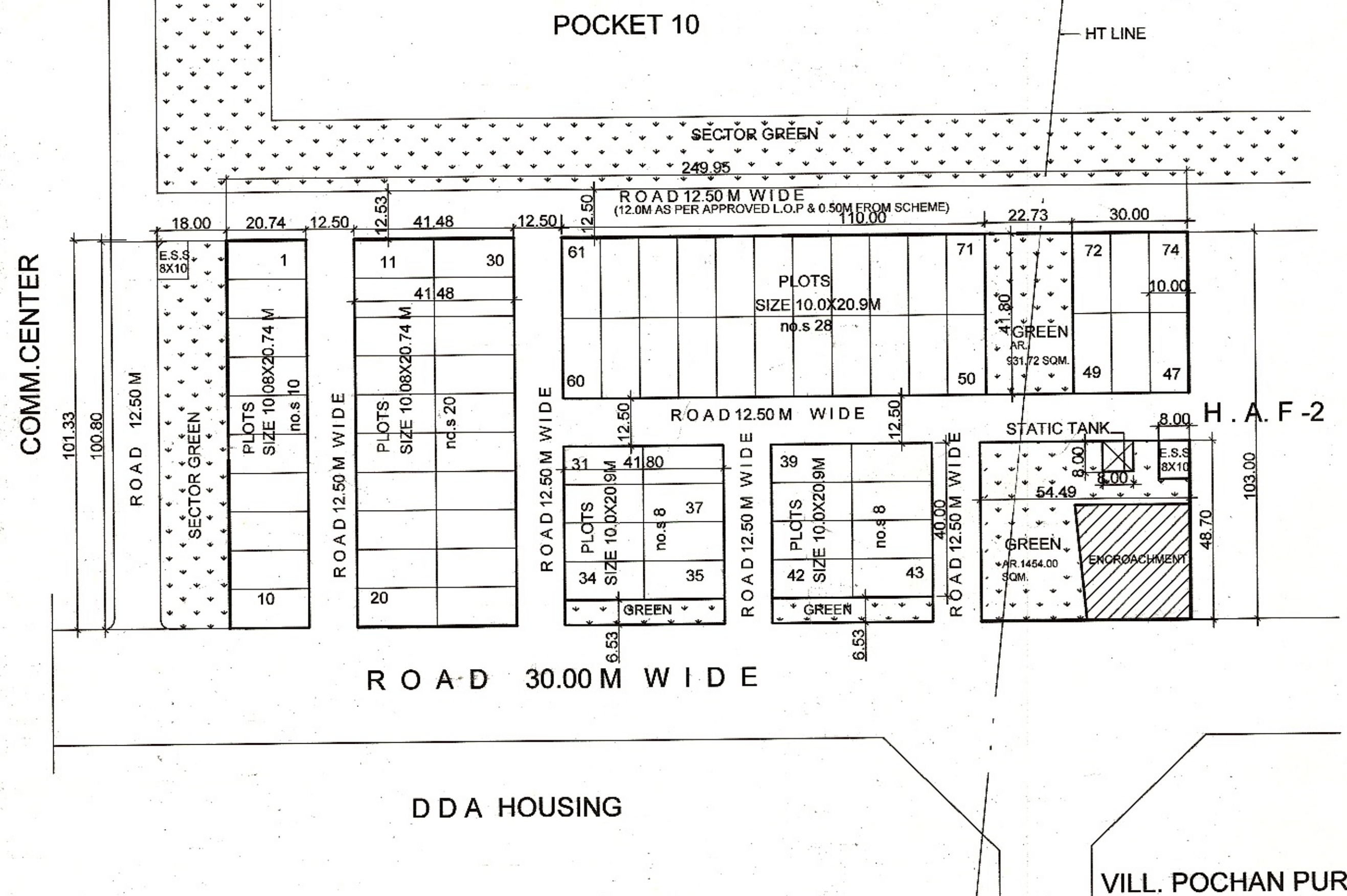
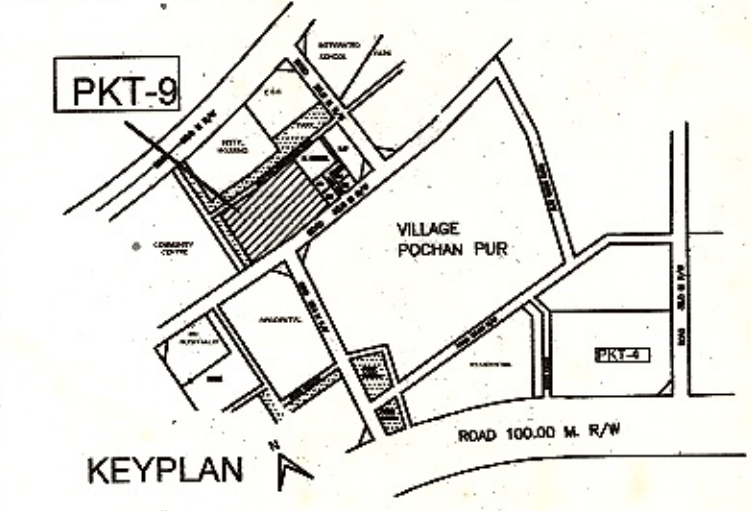

### AREA STATEMENT

TOTAL AREA OF POCKET = 2.61 HAC.

AREA UNDER PLOTS	= 15466 .00 SQ.M.	59.26%
AREA UNDER RECREATIONAL	= 3033.23 SQ.MT.	11.62%
AREA UNDER CIRCULATION	= 6602.77 SQ.MT.	25.30%
AREA UNDER UTILITY	= 144.00 SQ.M.	0.55%
AREA UNDER ENCROACHMENT	= 854.00 SQ.M.	3.27%

AREA UNDER UTILITY (ADJ. TO THIS POCKET) = 80.00 SQ.M.

### PLOTS DETAILS

NO. OF PLOTS	SIZE	AREA IN sq. m	AREA IN sq yds	PLOT NOS
30	10.08m x 20.74m	209.00	250	1to30
44	10.0m x 20.9m	209.00	250	31to74

E.S.S-2

### NOTES

- 1- THE PLAN ARE BASED ON TOTAL STATION SURVEY SUBMITTED BY EX. EN. WD -12 VIDE LETTER NO.DB/128/AE(P) /WD -12 /DDA /49 DATED 16.6 .07.
- 2- THE LAYOUT PLAN WAS APPROVED BY SCREENING COMMITTEE VIDE ITEM NO. 75:208 DATED 2-5-08.
- 3- THE LAYOUT PLAN MODIFIED ON THE BASIS OF FEASIBILITY REPORT OF EX. EN: WD -12 VIDE LETTER NO. DB/128/AE(P) WD-12/DDA/1366 DATED 17-9-08.
- 4- ALL GREEN TO BE MAINTAINED BY HORT. DEPTT.

THE REVISED L.O.P. IS APPROVED IN THE 270th SCREENING COMMITTEE MEETING HELD ON 24.10.08 VIDE ITEM NO 167:2008.IN FILE NO. F1 (76) PLG /DWK/07/PT-II.

THE LAYOUT PLAN FOR THE PLOTTED DEVELOPMENT WAS APPROVED SUBJECT TO ;

LAND DISPOSAL WING WILL DECIDE ABOUT THE MODE OF ALLOTMENT BY AUCTION / ALLOTMENT OF PLOTS LOCATED ON 100.0M/ 60.0M ROAD WITH THE APPROVAL OF THE COMPETENT AUTHORITY. IT WAS ALSO DECIDED THAT THE EQUIVALENT NO. OF PLOTS WHICH MAY BE UTILIZED FOR AUCTION MODE BE CARVED OUT ELSEWHERE FOR ALTERNATIVE PLOT ALLOTMENT.

### REVISED LAYOUT PLAN OF ALTERNATIVE PLOTS FOR RESIDENTIAL POCKET-9 SEC. 23 PH II

SCALE : 1: 1000	DWK/62/25/PH II/ALT-9/PKT-9/09/5d DRG. NO. D	DATE -SEP.2008
B.N.SHARMA PLG. D/MAN	MUKESH CHANDER RITA SEHGAL S.P KAUR PLG. ASSTT. 15-12-08	NORTH
N.R.ARAVIND ASSTT. DIR. (PLG.)	TAPAN MANDAL JT. DIRECTOR (PLG.)	S.P. PATHAK DIRECTOR (PLG.)

DELHI DEVELOPMENT AUTHORITY